

EVERCOUCH™

Replacing Sofa Back

1 Remove Suspension Lid

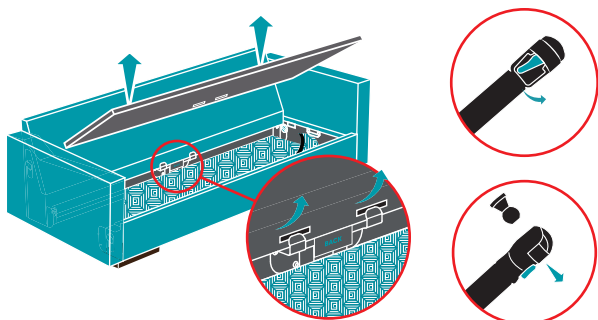

Remove Cushions and Back Pillows, and open Suspension Lid. With Suspension Lid open, hold teal switch at the top of the thick end of Slow-Close Mechanism to the right and pull to release. Repeat on the thin end of the Slow-Close Mechanism. Remove Suspension Lid.

2 Remove Thumb Screws, Pins, and Arms

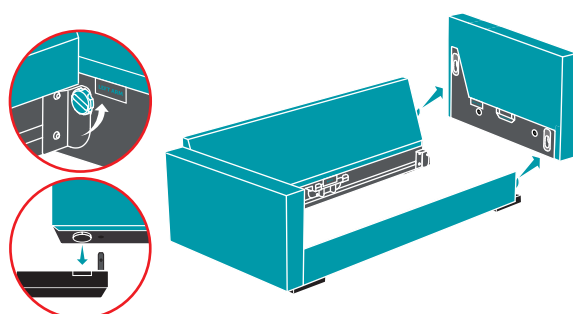

Remove Thumb Screws from all four corners inside the Seat Frame. Use handles to gently remove each Arm. Remove Steel Pins from both Back Sockets. Pull off Feet. Remove Cover and set aside.

3 Cover Back

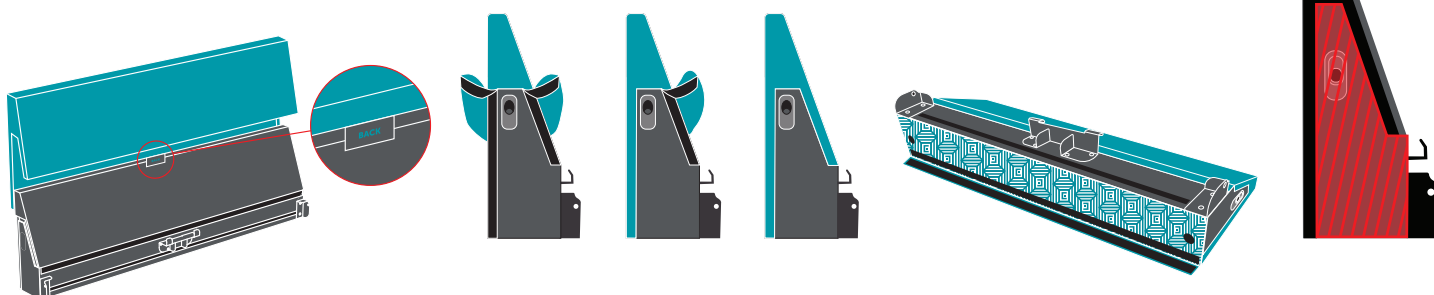

Important: Cover must avoid connection zone (highlighted above in red) or EverCouch will not assemble properly.

Locate Cover labeled "Back." With the shorter side of Cover facing Back brackets, align top four corners and pull Cover over Back ensuring seams are aligned. Secure hook and loop strips on the rear sides of the Back. Secure hook and loop strips on the front sides of Back. Lay Back down to secure hook and loop strips on bottom.

4 Install Feet on Back

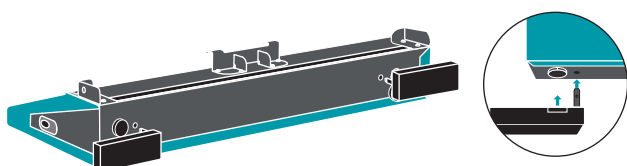

Lay Back flat on the ground. Partially insert the pin (connected to the top of the Foot) into one of the holes on the bottom of the Back. Align hole on Foot with Foot Peg located on the bottom of the Back and press to secure. Repeat on other side so both Feet are installed. Add felt pads as needed.

5 Complete Setup

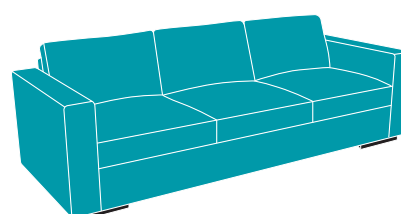

Follow steps 4.1 through 7 in EverCouch Setup Guide to complete setup.

[Click Here to view complete EverCouch Setup Guide](#)

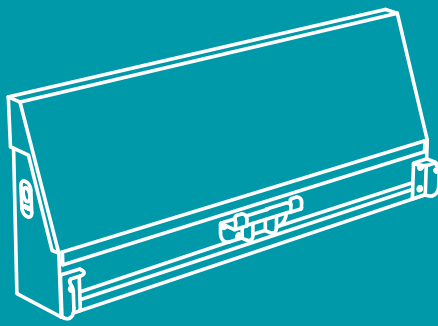

EVERCOUCH™

Replacing Loveseat Back

1 Remove Suspension Lid

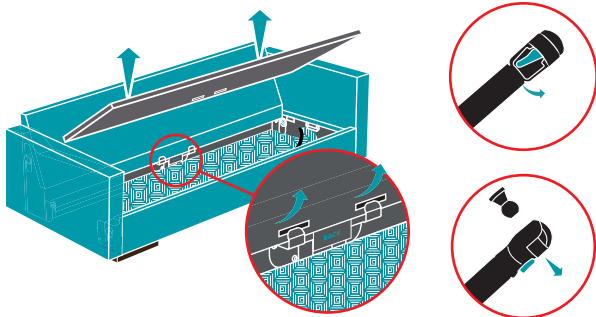

Remove Cushions and Back Pillows, and open Suspension Lid. With Suspension Lid open, hold teal switch at the top of the thick end of Slow-Close Mechanism to the right and pull to release. Repeat on the thin end of the Slow-Close Mechanism. Remove Suspension Lid.

2 Remove Thumb Screws, Pins, and Arms

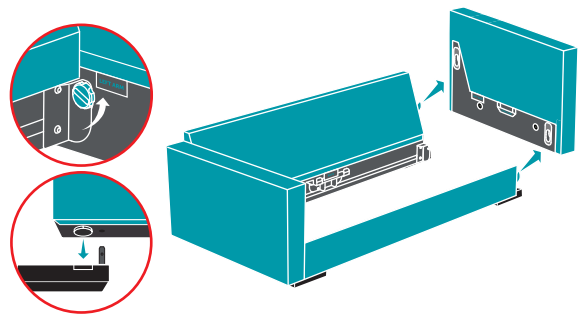

Remove Thumb Screws from all four corners inside the Seat Frame. Use handles to gently remove each Arm. Remove Steel Pins from both Back Sockets. Pull off Feet. Remove Cover and set aside.

3 Cover Back

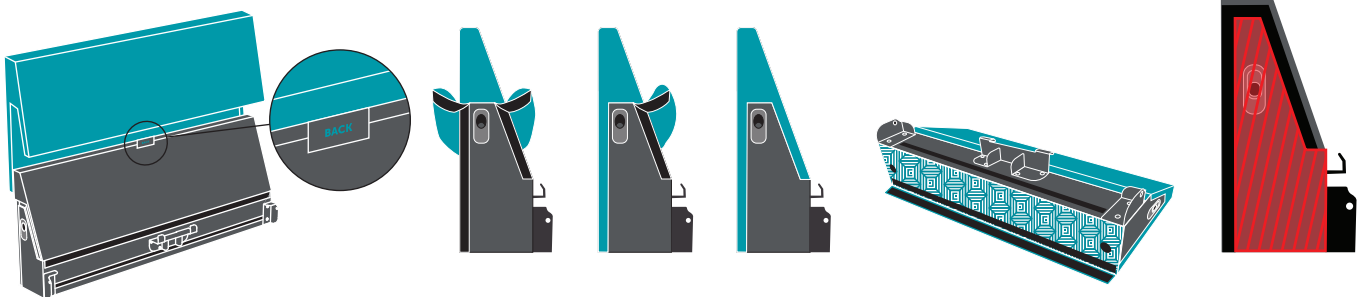

Important: Cover must avoid connection zone (highlighted above in red) or EverCouch will not assemble properly.

Locate Cover labeled "Back." With the shorter side of Cover facing Back brackets, align top four corners and pull Cover over Back ensuring seams are aligned. Secure hook and loop strips on the rear sides of the Back. Secure hook and loop strips on the front sides of Back. Lay Back down to secure hook and loop strips on bottom.

4 Install Feet on Back

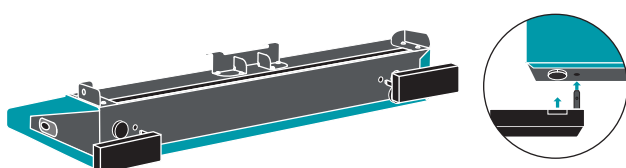

Lay Back flat on the ground. Partially insert the pin (connected to the top of the Foot) into one of the holes on the bottom of the Back. Align hole on Foot with Foot Peg located on the bottom of the Back and press to secure. Repeat on other side so both Feet are installed. Add felt pads as needed.

5 Complete Setup

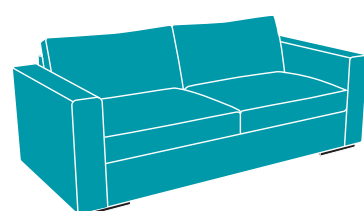

Follow steps 4.1 through 7 in EverCouch Setup Guide to complete setup.

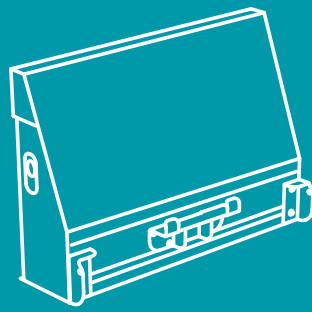

EVERCOUCH™

Replacing Chair Back

1 Remove Suspension Lid

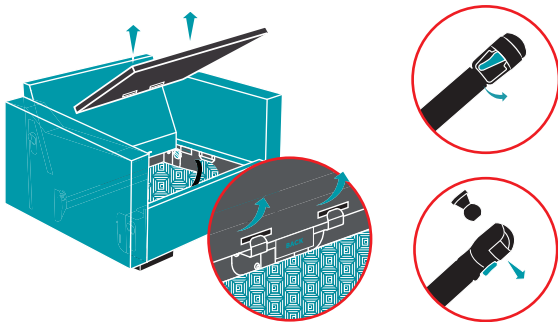

Remove Cushions and Back Pillows, and open Suspension Lid. With Suspension Lid open, hold teal switch at the top of the thick end of Slow-Close Mechanism to the right and pull to release. Repeat on the thin end of the Slow-Close Mechanism. Remove Suspension Lid.

2 Remove Thumb Screws, Pins, and Arms

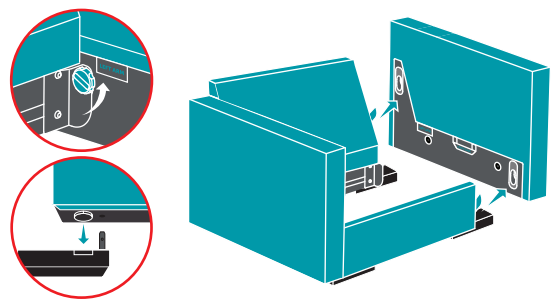

Remove Thumb Screws from all four corners inside the Seat Frame. Use handles to gently remove each Arm. Remove Steel Pins from both Back Sockets. Pull off Feet. Remove Cover and set aside.

3 Cover Back

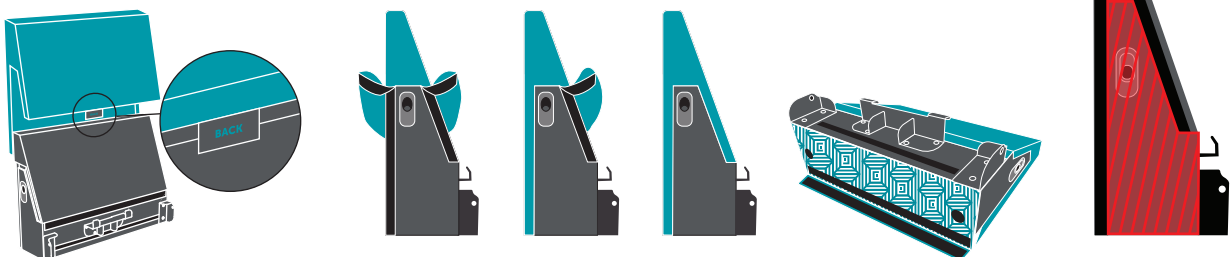

Important: Cover must avoid connection zone (highlighted above in red) or EverCouch will not assemble properly.

Locate Cover labeled "Back." With the shorter side of Cover facing Back brackets, align top four corners and pull Cover over Back ensuring seams are aligned. Secure hook and loop strips on the rear sides of the Back. Secure hook and loop strips on the front sides of Back. Lay Back down to secure hook and loop strips on bottom.

4 Install Feet on Back

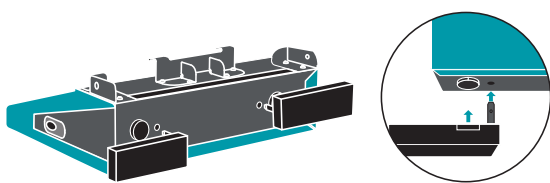

Lay Back flat on the ground. Partially insert the pin (connected to the top of the Foot) into one of the holes on the bottom of the Back. Align hole on Foot with Foot Peg located on the bottom of the Back and press to secure. Repeat on other side so both Feet are installed. Add felt pads as needed.

5 Complete Setup

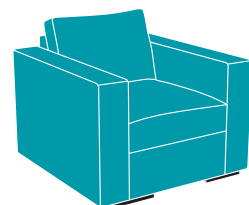

Follow steps 4.1 through 7 in EverCouch Setup Guide to complete setup.

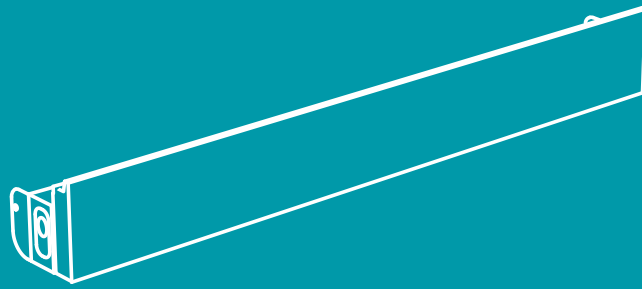

EVERCOUCH™

Replacing Sofa Beam

1 Disassemble the Sofa to Install the new Beam

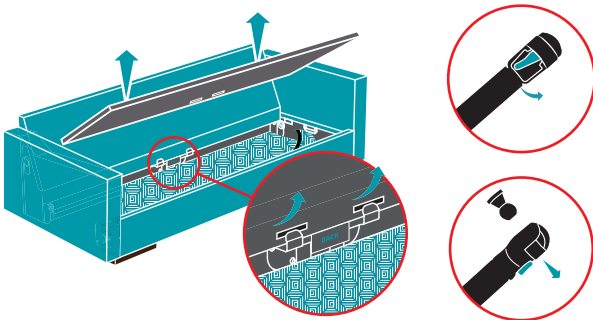

Remove Cushions and Back Pillows, and open Suspension Lid. With Suspension Lid open, hold teal switch at the top of the thick end of Slow-Close Mechanism to the right and pull to release. Repeat on the thin end of the Slow-Close Mechanism.

2 Remove the Thumb Screws, Pins, and Arms

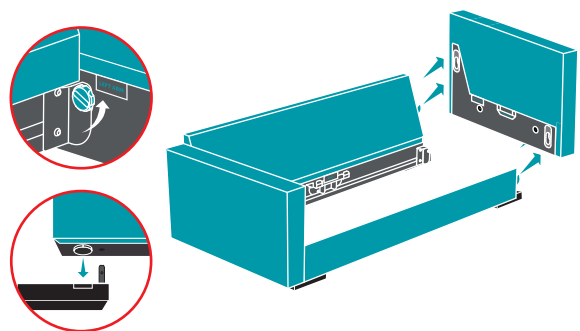

Remove Thumb Screws from all four corners inside the Seat Frame. Use handles to gently remove each Arm. Remove Steel Pins from both Beam Sockets. Pull off Feet. Remove Cover and set aside.

3 Cover Beam

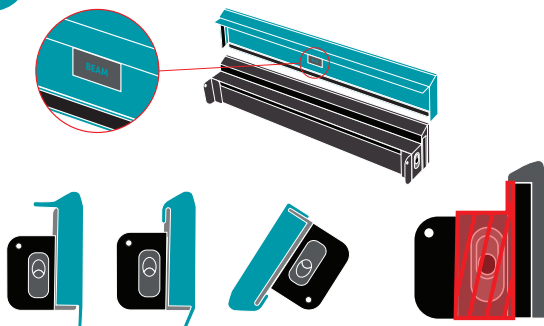

Important: Cover must avoid connection zone (highlighted above in red) or EverCouch will not assemble properly.

Locate Cover labeled "Beam". With shorter side of Cover facing Beam brackets, align top four corners and pull Cover over Beam ensuring seams are aligned. Secure hook and loop strips on sides first, then attach hook and loop strips on top. Flip Beam over to secure hook and loop strips on bottom.

4 Install Feet on Beam

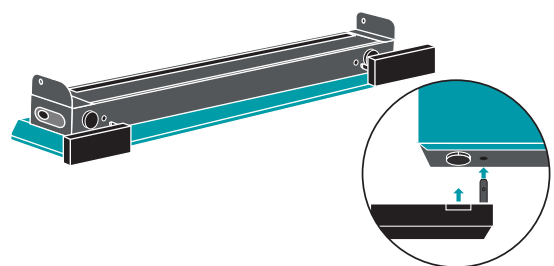

Lay Beam flat on the ground. Partially insert the pin (connected to the top of the Foot) in one of the holes on the bottom of the Beam. Align hole on Foot with Foot Peg located on the bottom of the Beam and press to fully secure. Repeat so both Feet are installed. Add felt pads as needed.

5 Complete EverCouch Setup

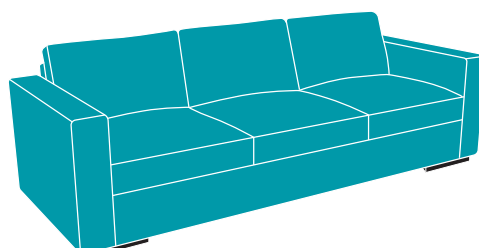

Follow steps 4.1 through 7 in EverCouch Setup Guide to complete setup.

[Click Here to view complete EverCouch Setup Guide](#)



EVERCOUCH™

Replacing Lovesac Beam

1 Disassemble the Lovesac to Install the new Beam

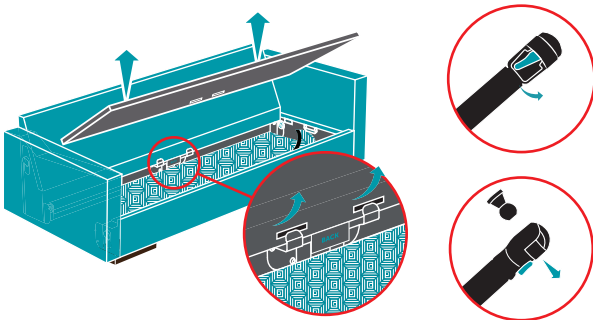

Remove Cushions and Back Pillows, and open Suspension Lid. With Suspension Lid open, hold teal switch at the top of the thick end of Slow-Close Mechanism to the right and pull to release. Repeat on the thin end of the Slow-Close Mechanism.

2 Remove the Thumb Screws, Pins, and Arms

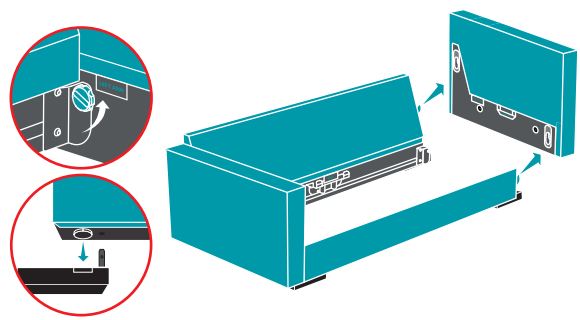

Remove Thumb Screws from all four corners inside the Seat Frame. Use handles to gently remove each Arm. Remove Steel Pins from both Beam Sockets. Pull off Feet. Remove Cover and set aside.

3 Cover Beam

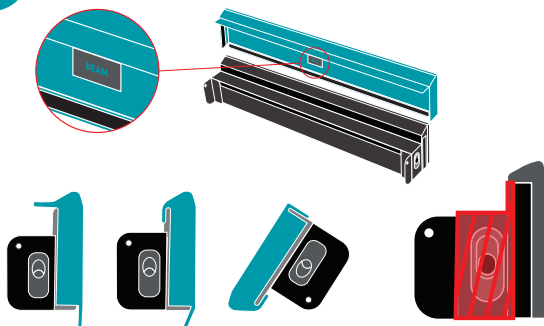

Important: Cover must avoid connection zone (highlighted above in red) or EverCouch will not assemble properly.

Locate Cover labeled "Beam". With shorter side of Cover facing Beam brackets, align top four corners and pull Cover over Beam ensuring seams are aligned. Secure hook and loop strips on sides first, then attach hook and loop strips on top. Flip Beam over to secure hook and loop strips on bottom.

4 Install Feet on Beam

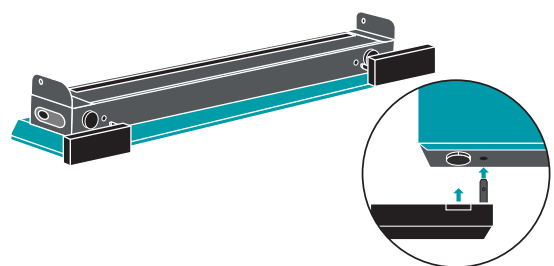

Lay Beam flat on the ground. Partially insert the pin (connected to the top of the Foot) in one of the holes on the bottom of the Beam. Align hole on Foot with Foot Peg located on the bottom of the Beam and press to fully secure. Repeat so both Feet are installed. Add felt pads as needed.

5 Complete EverCouch Setup

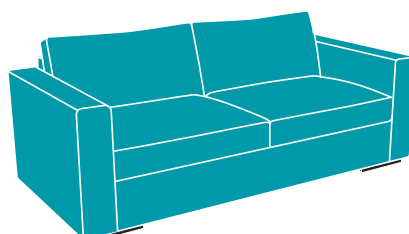

Follow steps 4.1 through 7 in EverCouch Setup Guide to complete setup.

[Click Here to view complete EverCouch Setup Guide](#)



EVERCOUCH™

Replacing Chair Beam

1 Disassemble the Chair to Install the new Beam

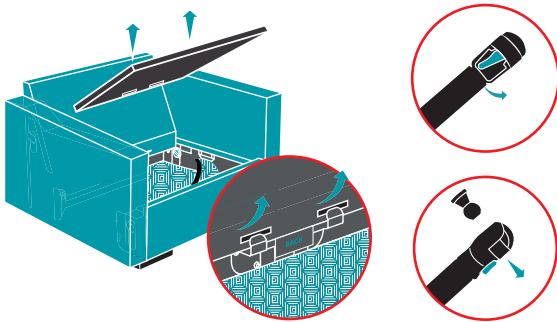

Remove Cushions and Back Pillows, and open Suspension Lid. With Suspension Lid open, hold teal switch at the top of the thick end of Slow-Close Mechanism to the right and pull to release. Repeat on the thin end of the Slow-Close Mechanism.

2 Remove the Thumb Screws, Pins, and Arms

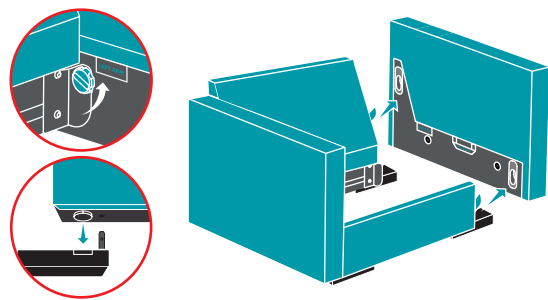

Remove Thumb Screws from all four corners inside the Seat Frame. Use handles to gently remove each Arm. Remove Steel Pins from both Beam Sockets. Pull off Feet. Remove Cover and set aside.

3 Cover Beam

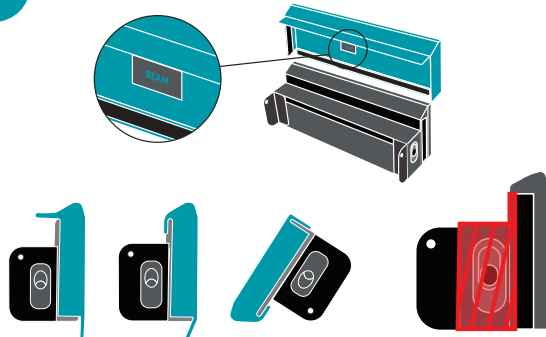

Important: Cover must avoid connection zone (highlighted above in red) or EverCouch will not assemble properly.

Locate Cover labeled "Beam". With shorter side of Cover facing Beam brackets, align top four corners and pull Cover over Beam ensuring seams are aligned. Secure hook and loop strips on sides first, then attach hook and loop strips on top. Flip Beam over to secure hook and loop strips on bottom.

4 Install Feet on Beam

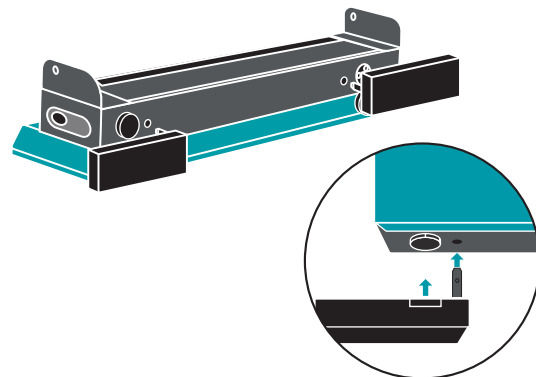

Lay Beam flat on the ground. Partially insert the pin (connected to the top of the Foot) in one of the holes on the bottom of the Beam. Align hole on Foot with Foot Peg located on the bottom of the Beam and press to fully secure. Repeat so both Feet are installed. Add felt pads as needed.

5 Complete EverCouch Setup

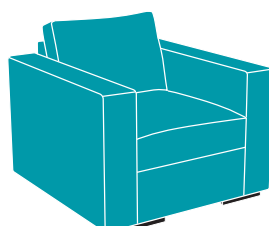

Follow steps 4.1 through 7 in EverCouch Setup Guide to complete setup.

[Click Here to view complete EverCouch Setup Guide](#)

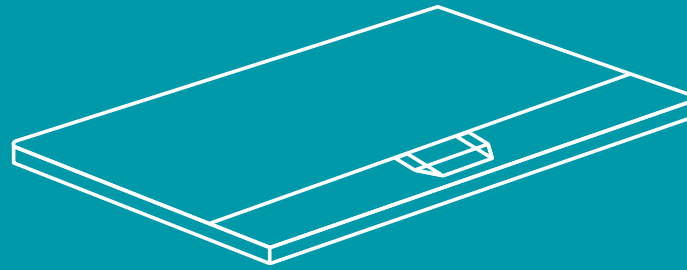

EVERCOUCH™

Replacing EverCouch Suspension Lid

1 Remove Back Pillows and Seat Cushions Lift open Suspension Lid

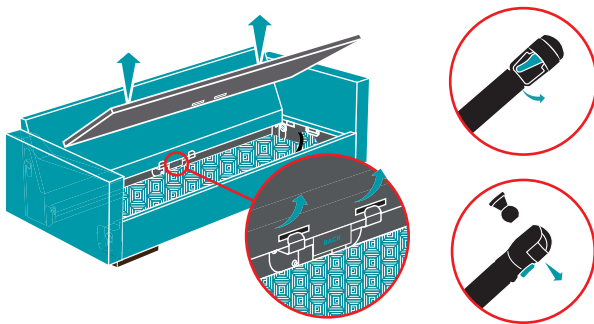

Remove Cushions and Back Pillows, and open Suspension Lid. With Suspension Lid open, hold teal switch at the top of the thick end of Slow-Close Mechanism to the right and pull to release. Rest Slow-Close Mechanism on Storage Sling. Using handle, carefully lift Suspension Lid out of the brackets, and place aside.

2 Slide replacement Suspension Lid into Brackets

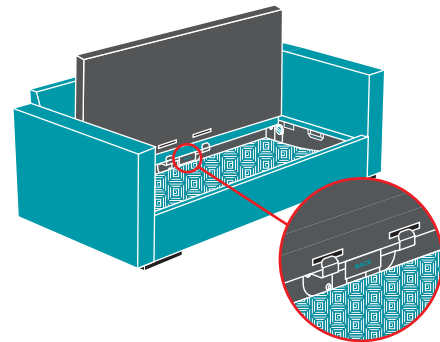

Locate handle on Suspension Lid, carefully lift Suspension Lid into a vertical position. Standing behind EverCouch with handle facing towards you, slide the Suspension Lid into the bracket hooks on Back to secure.

3 Attach Slow-Close Mechanism to Suspension Lid

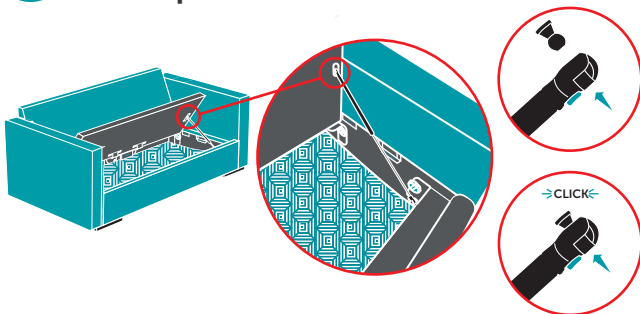

Attach the thick end of Slow-Close Mechanism to the peg on the bottom of the Suspension Lid by applying firm pressure until it clicks into place. Close Suspension Lid.

4 Place Seat Cushions & Back Pillows

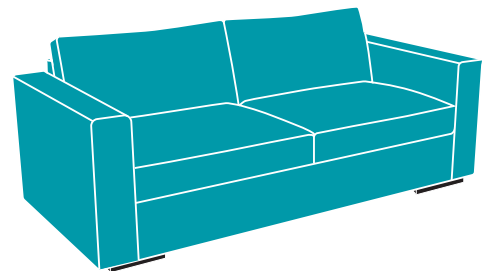

Place Seat Cushions on Suspension Lid, followed by Back Pillows. Sit back and enjoy your EverCouch!



EVERCOUCH™

Covering EverCouch Arm Pillows

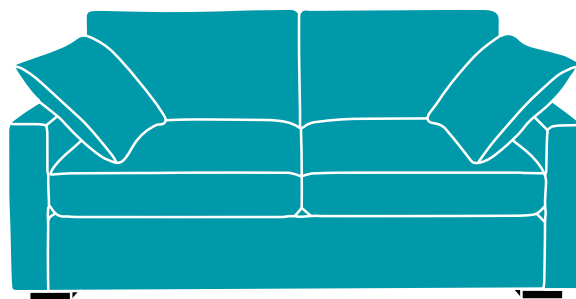
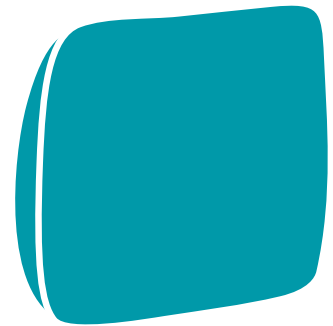
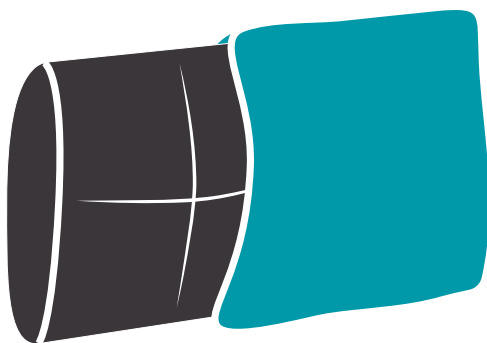

Position Cover over the Arm Pillow, ensuring Insert and Cover zippers are on the same side and that seams and edges are aligned. Pull Cover over Insert. Starting from the middle, push corners of the Insert outwards, filling the Cover corners for a snug fit. Smooth the fabric, ensuring it's wrinkle-free, and zip the Cover closed. Drape Pillows over EverCouch Arms as shown above.

[Click Here to view complete EverCouch Setup Guide](#)



EVERCOUCH™

Covering EverCouch Back Pillows

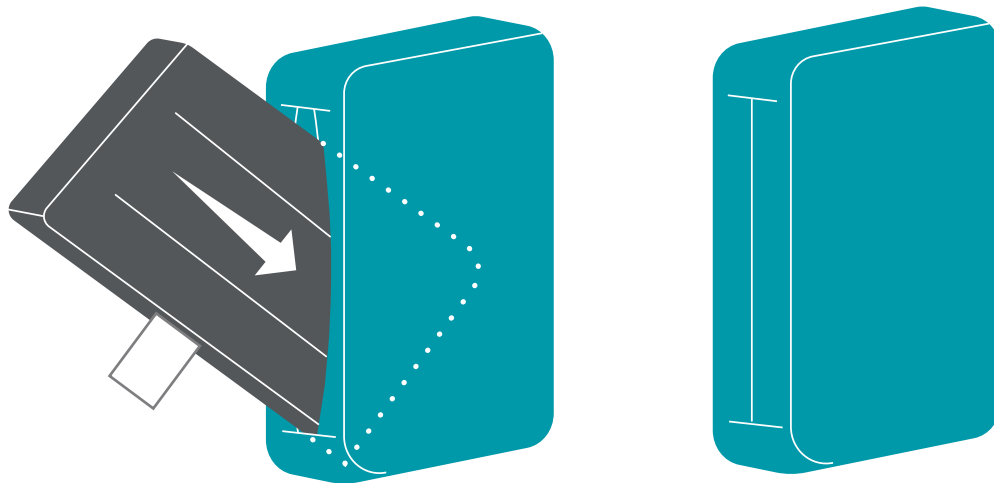

Insert Back Pillow into Back Pillow Cover, ensuring all labels are at the bottom. Carefully zip closed, ensuring Cover edges are straight. Place on your EverCouch and enjoy.

[Click Here to view complete EverCouch Setup Guide](#)

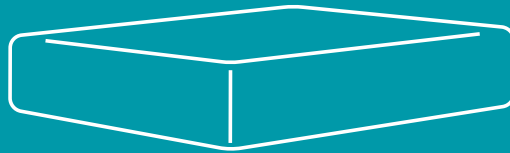

EVERCOUCH™

Covering EverCouch Seat Cushions

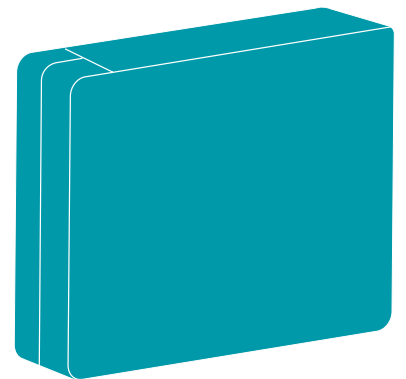
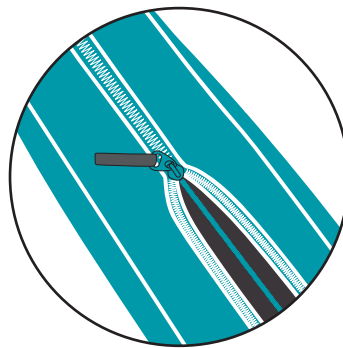
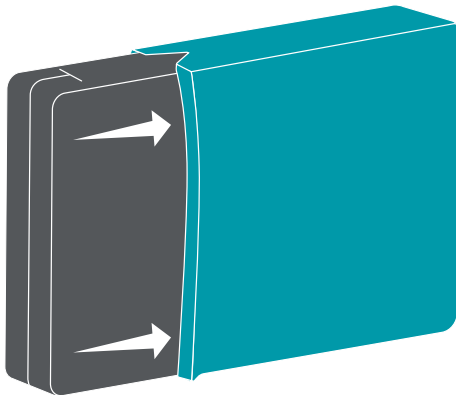

Position Cover over the Seat Cushion, ensuring Insert and Cover zippers are on the same side and that seams and edges are aligned. Locate zipper on the back of the Cover. Carefully zip closed, ensuring fabric remains smooth and wrinkle-free. Tuck zipper pull in pocket.

[Click Here to view complete EverCouch Setup Guide](#)

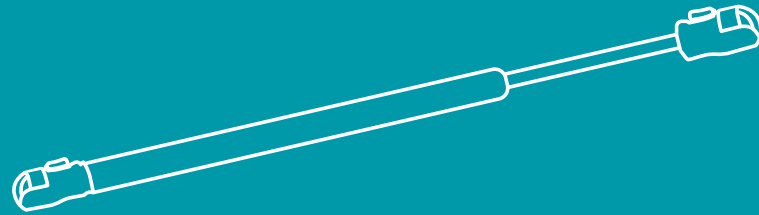

EVERCOUCH™

Replacing EverCouch Slow-Close Mechanism

1 Remove Slow-Close Mechanism from Suspension Lid

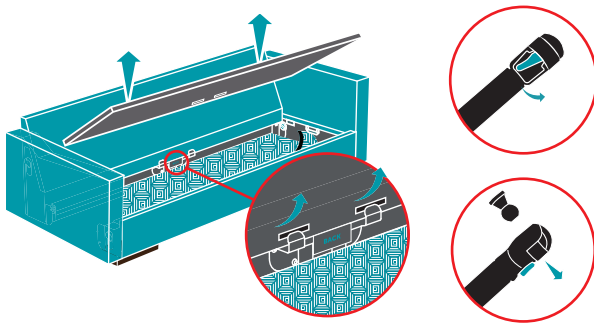

Remove Cushions and Back Pillows, and open Suspension Lid. With Suspension Lid secured open, hold teal switch at the top of the thick end of Slow-Close Mechanism to the right and pull to release. Repeat on the thin end of the Slow-Close Mechanism.

2 Remove the Slow-Close Mechanism from Beam

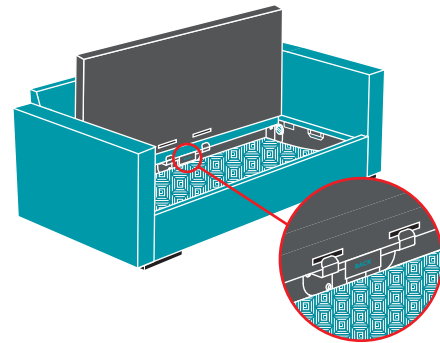

Have a partner hold the Suspension Lid to secure in place. On the thin end of the Slow-Close Mechanism slide the teal lever to the right and hold, then pull firmly to release Slow-Close Mechanism from the Beam.

3 Install replacement Slow-Close Mechanism

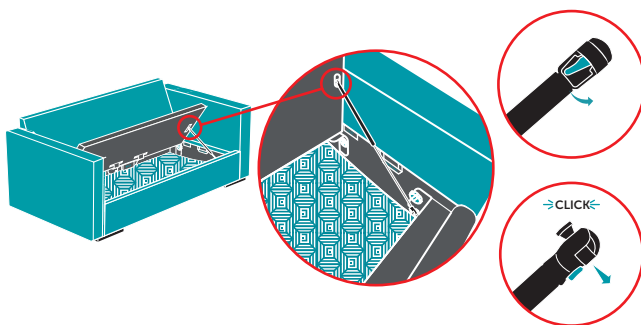

Attach the thick end of Slow-Close Mechanism to the peg on the bottom of the Suspension Lid by applying firm pressure until it clicks into place. Then attach Slow-Close Mechanism to peg on Beam. Close Suspension Lid.

4 Add Cushions and Back Pillows

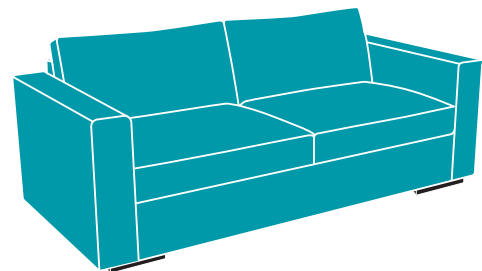

Place Seat Cushions on Suspension Lid, followed by Back Pillows. Sit back and enjoy your EverCouch!

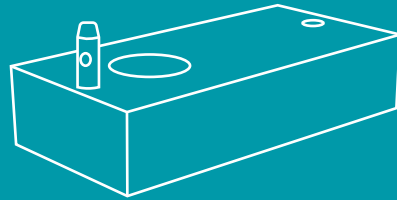

EVERCOUCH™

Replacing EverCouch Feet

1 Remove Feet

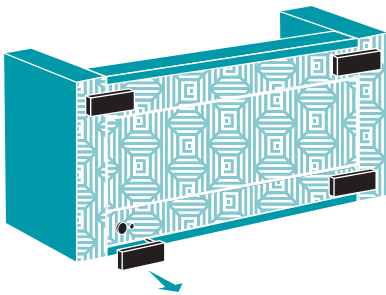

Remove Seat Cushions and Back Pillows. Lay the EverCouch flat on the ground to access Feet (This is easier with two people.) Pull gently on Feet to remove.

2 Install new Feet

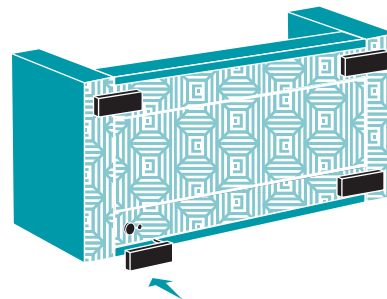

Partially insert the pin (attached to the top of the Foot) into holes on the bottom of Beam or Back. Align the hole on the Foot with the Foot Peg located on the bottom of Beam or Back, then press down to fully secure. Add felt pads as needed.

3 Add Seat Cushions and Back Pillows

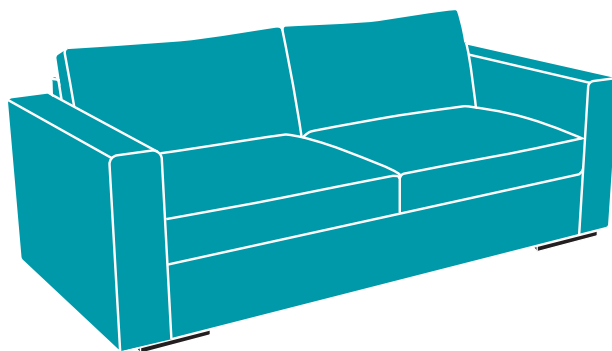

With 2 people, tilt EverCouch back on it's Feet. Add Back Pillows and Seat Cushions. Sit back and enjoy your EverCouch!

[Click Here to view complete EverCouch Setup Guide](#)



EVERCOUCH™

Replacing EverCouch Thumb Screw

- 1** Remove Back Pillows and Seat Cushions
Lift open Suspension Lid

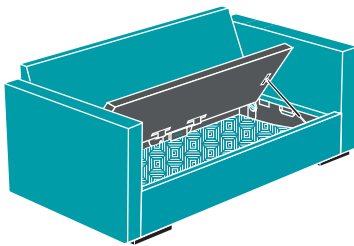

Remove Back Pillows, Seat Cushions, lift open Suspension Lid to access the Thumb Screws.

- 2** Remove current Thumb Screw

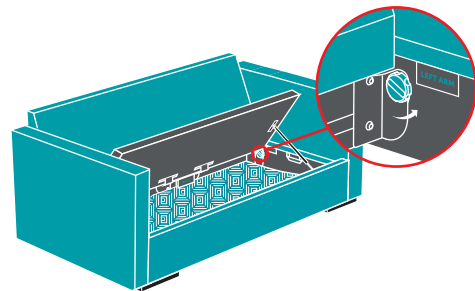

Remove current Thumb Screw(s) that needs to be replaced.

- 3** Secure replacement Thumb Screw(s)

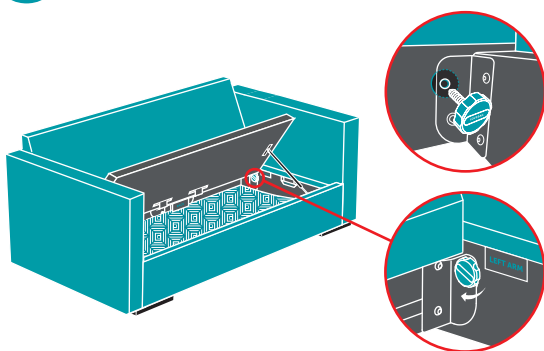

Shift pieces as needed to ensure the holes in corner brackets are aligned with Thumb Screw hole. Insert and tighten Thumb Screw until secure. Close Suspension Lid.

- 4** Add Seat Cushions and Back Pillows

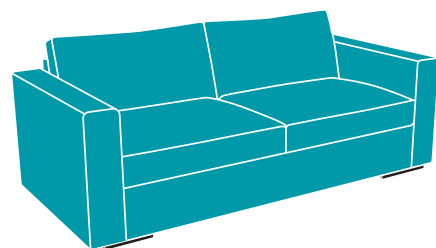

Place Seat Cushions on Suspension Lid, followed by Back Pillows. Sit back and enjoy your EverCouch!

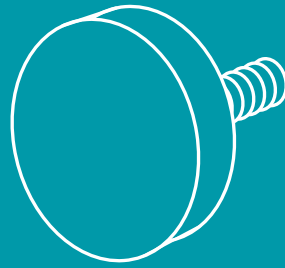

EVERCOUCH™

Replacing EverCouch Foot Peg

1 Remove Feet

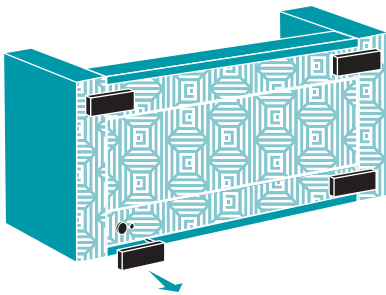

Remove Seat Cushions and Back Pillows. Lay the EverCouch flat on the ground to access Feet (This is easier with two people.) Pull gently on Feet to remove.

2 Remove Foot Peg

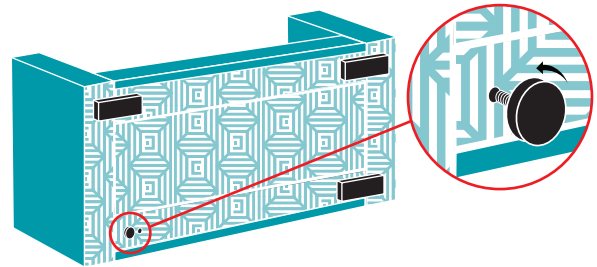

Remove current Foot Peg and discard.

3 Install new Foot Peg

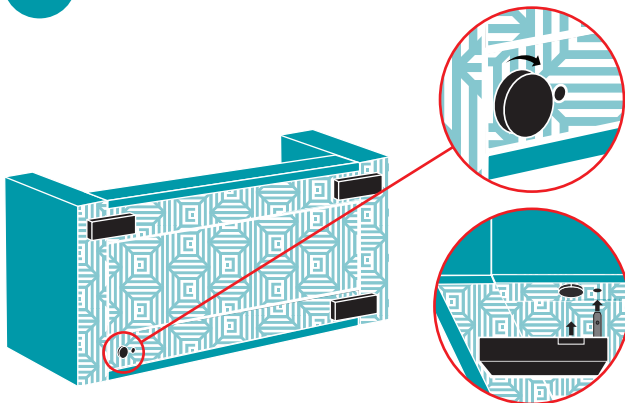

Hand-tighten the new Foot Peg until it is fully secure. Partially insert the pin (attached to the top of the Foot) into the holes on the bottom of the Beam or Back. Align the hole in the Foot with the Foot Peg below, then press down firmly to lock it into place.

4 Add Seat Cushions and Back Pillows

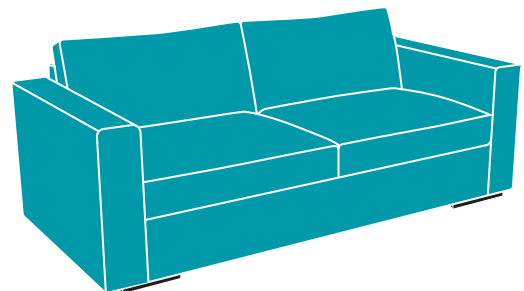

With 2 people, tilt EverCouch back on it's Feet. Add Back Pillows and Seat Cushions. Sit back and enjoy your EverCouch!

[Click Here to view complete EverCouch Setup Guide](#)

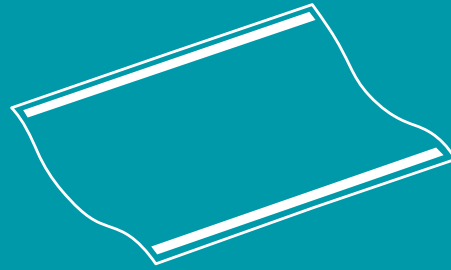

EVERCOUCH™

Replacing EverCouch Storage Sling

1 Remove Storage Sling

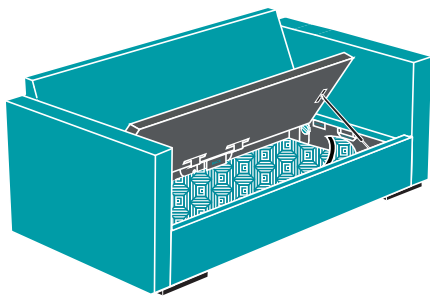

Remove Seat Cushions and Back Pillows and lift open Suspension Lid. Grab any corner of current Storage Sling and pull to remove.

2 Secure to Back

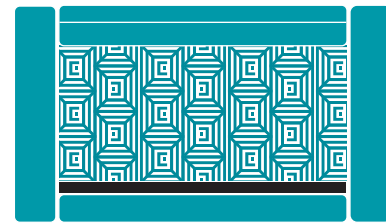

TOP VIEW

Unfold Storage Sling and lay inside of Seat Frame. Align pair of hook and loop strips on Storage Sling and Back, pressing to secure.

3 Secure to Beam

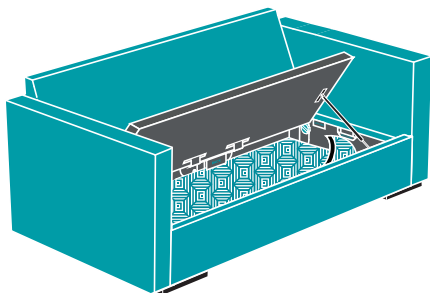

Align pair of hook and loop strips on Storage Sling and Beam, pressing to secure. Close Slow-Close Suspension Lid.

4 Add Seat Cushions and Back Pillows

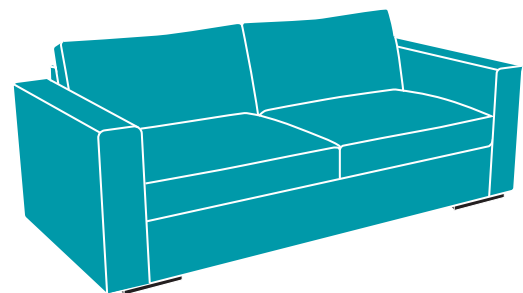

Place Seat Cushions on Suspension Lid, followed by Back Pillows. Sit back and enjoy your EverCouch!

[Click Here to view complete EverCouch Setup Guide](#)